

SITE MAP
SCALE : NTS

PLAN VIEW
SCALE 1"=30'

⊗	POWER POLE	0/0	■	LOCK BOX	0	*	NEW BUILD	0	—	ROAD BORE FTG	0	○	AER SINGLE DWELL. ACT./POT.	0/	FIELD	DATE:
○	TELEPHONE POLE	0/0	Ⓜ	MANHOLE	0	●	CHANGE OF DIRECTION	0	—	NEW ROAD BORE FTG	0	○	U/G SINGLE DWELL. ACT./POT.	0/	BY:	-/-
⊕	JOINT POLE	0/0	Ⓜ	PEDESTAL	0	▶	DOWN GUY/ANCHOR	0	—	AERIAL BUILT FTG	0	□	MDU	0	ROUTED	DATE:
⊗	CATV POLE	0/0	Ⓜ	VAULT	0	▶	SET ANCHOR	0	—	U/G BUILT FTG	0	□	MOTEL UNITS	0	BY:	-/-
⊗	POWER TRANSFORMER	0/0	⊗	POWER PED	0	▶	SIDEWALK ANCHOR	0	—	AERIAL NEW BUILT FTG	0	△	TOTAL COMMERCIAL	0	DESIGN	DATE:
⊗	JOINT TRANSFORMER	0/0	⊗	JOINT TRANS PED	0	▶	SIDEWALK SET ANCHOR	0	—	U/G NEW BUILT FTG	0	△	TOTAL CUSTOMERS	0	BY:	
⊗	METAL POLE	0/0	⊗	TRANS PED	0	▶	POLE TO POLE GUY	0	—	TOTAL FOOTAGE	0	△	DENSITY PER MILE	0	DES-DRAFT	DATE:
⊗	CONCRETE POLE	0/0	⊗	TELEPHONE PED	0	▶	OVERHEAD GUY	0	—	TOTAL BUILT MILES	0	△	POLE TRANSFERS	0	BY:	
⊗	TOTAL POLES	0/ 0/0	⊗	TOTAL PEDS	0	⊕	RISER	0	—	TOTAL NEW BUILT MILES	0	△	DROP SWAP	0	REVISIONS	

SYSTEM NAME: LITTLE ROCK SCHOOL DISTRICT	
LOCATION: LITTLE ROCK, AR	
DRAWING NAME:	PROJECT NAME: LITTLE ROCK SCHOOL DISTRICT
30 at E 17th St	PROJECT NUMBER: 13-4525
PAGE 1 OF 4	

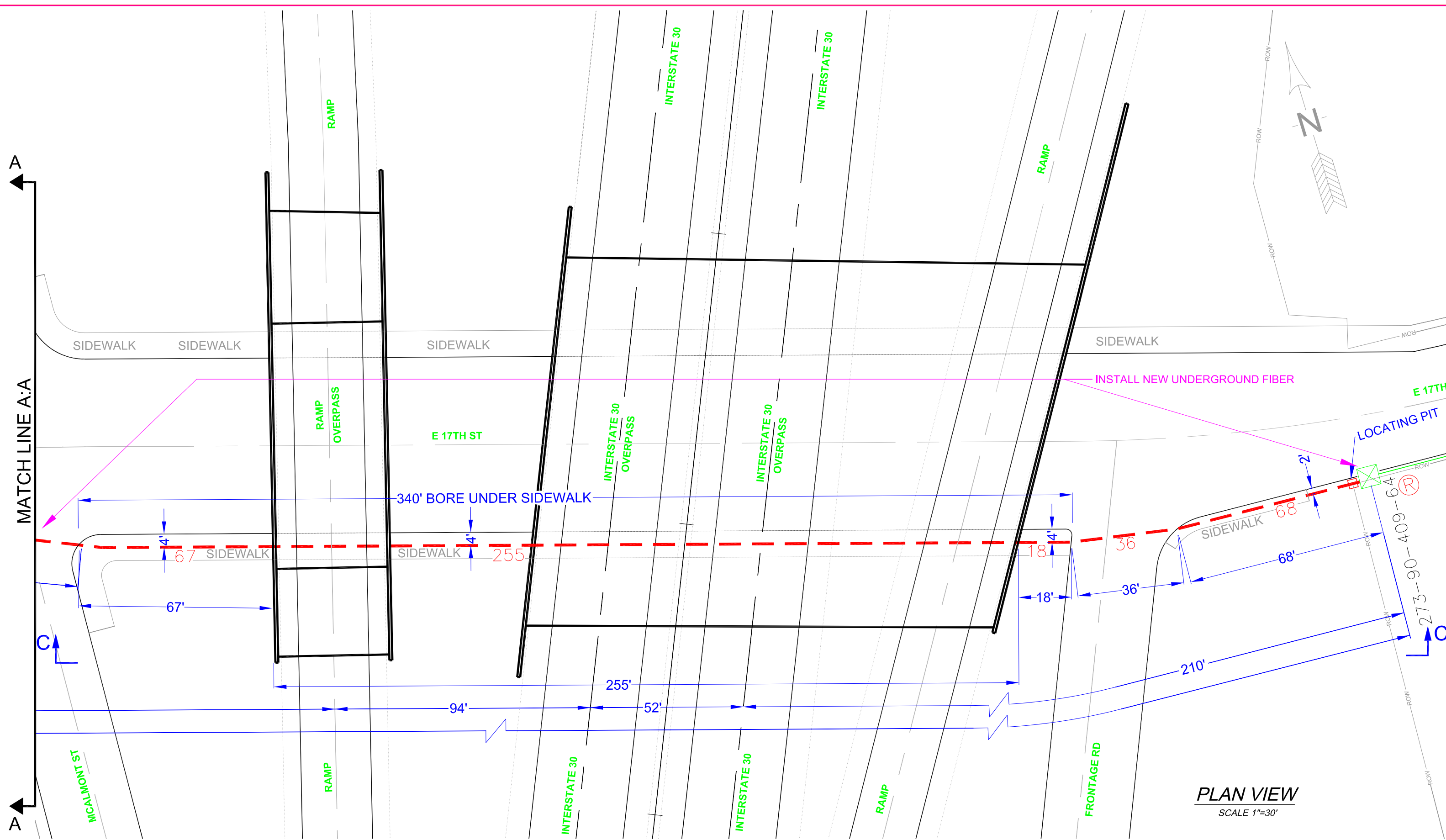

PLAN VIEW
SCALE 1"=30'

⊗	POWER POLE	0/0	■	LOCK BOX	0	*	NEW BUILD	—	ROAD BORE FTG	0	○	AER SINGLE DWELL. ACT./POT.	0/
⊗	TELEPHONE POLE	0/0	⊞	MANHOLE	0	●	CHANGE OF DIRECTION	—	NEW ROAD BORE FTG	0	○	U/G SINGLE DWELL. ACT./POT.	0/
⊗	JOINT POLE	0/0	⊞	PEDESTAL	0	→	DOWN GUY/ANCHOR	0	AERIAL BUILT FTG	0	□	MDU	0
⊗	CATV POLE	0/0	⊞	VAULT	0	→	SET ANCHOR	0	U/G BUILT FTG	0	□	MOTEL UNITS	0
⊗	POWER TRANSFORMER	0/0	⊞	POWER PED	0	→	SIDEWALK ANCHOR	0	AERIAL NEW BUILT FTG	0	△	TOTAL COMMERCIAL	0
⊗	JOINT TRANSFORMER	0/0	⊞	JOINT TRANS PED	0	→	SIDEWALK SET ANCHOR	0	U/G NEW BUILT FTG	0	△	TOTAL CUSTOMERS	0
⊗	METAL POLE	0/0	⊞	TRANS PED	0	→	POLE TO POLE GUY	0	TOTAL FOOTAGE	0	△	DENSITY PER MILE	0
⊗	CONCRETE POLE	0/0	⊞	TELEPHONE PED	0	→	OVERHEAD GUY	0	TOTAL BUILT MILES	0	△	POLE TRANSFERS	0
⊗	TOTAL POLES	0/0	⊞	TOTAL PEDS	0	⊕	RISER	0	TOTAL NEW BUILT MILES	0	△	DROP SWAP	0

FIELD	DATE:	REVISIONS	SCALE:
BY:	-/-	1	0 50'
ROUTED	DATE:	2	SCALE:
BY:	-/-	3	⊞
DESIGN	DATE:		
BY:			
DES-DRAFT	DATE:		
BY:			

SYSTEM NAME: LITTLE ROCK SCHOOL DISTRICT	
LOCATION: LITTLE ROCK, AR	
DRAWING NAME:	PROJECT NAME: LITTLE ROCK SCHOOL DISTRICT
30 at E 17th St	PROJECT NUMBER: 13-4525
PAGE 2 OF 4	

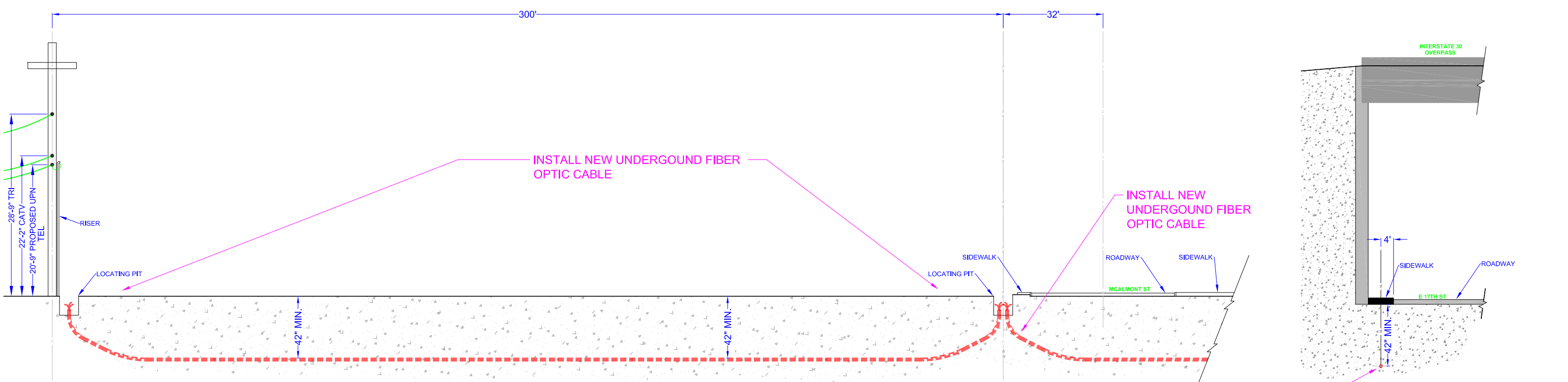

ELEVATION B:B
 LOOKING NORTH
 SCALE:
 X: 1"=30'
 Y: 1"=15'

CROSS SECTION D:D
 LOOKING WEST
 SCALE:
 X: 1"=30'
 Y: 1"=15'

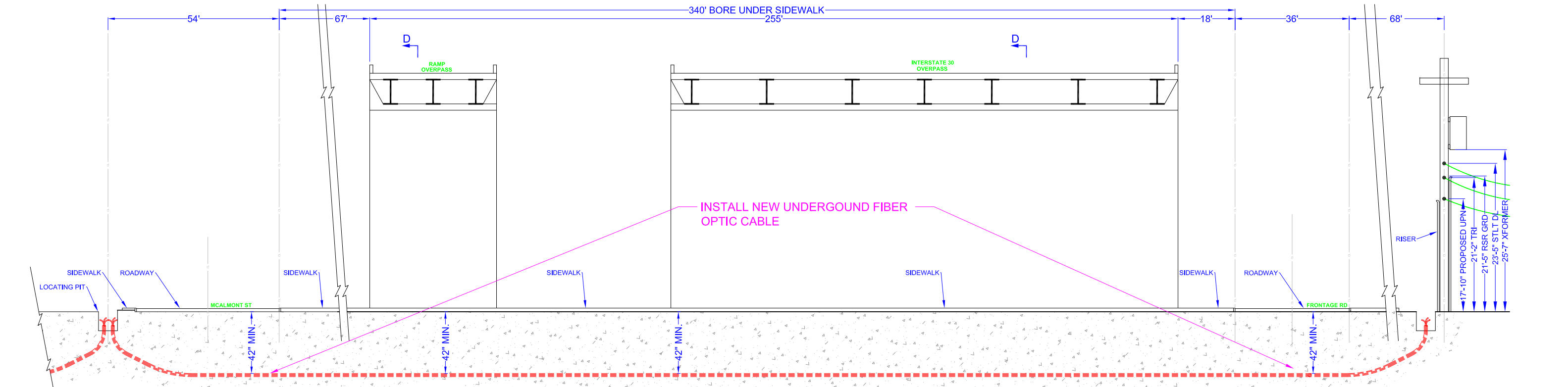

ELEVATION C:C
 LOOKING NORTH
 SCALE:
 X: 1"=30'
 Y: 1"=15'

☒ POWER POLE	0/0	☐ LOCK BOX	0	✱ NEW BUILD	—	⊖ ROAD BORE FTG	0	⊖ AER SINGLE DWELL. ACT./POT.	0/-	FIELD	DATE:
⊖ TELEPHONE POLE	0/0	⊖ MANHOLE	0	● CHANGE OF DIRECTION	—	⊖ NEW ROAD BORE FTG	0	⊖ U/G SINGLE DWELL. ACT./POT.	0/-	BY:	-/-
⊖ JOINT POLE	0/0	⊖ PEDESTAL	0	➔ DOWN GUY/ANCHOR	0	⊖ AERIAL BUILT FTG	0	⊖ MDU	0	ROUTED	DATE:
⊖ CATV POLE	0/0	⊖ VAULT	0	⊖ SET ANCHOR	0	⊖ U/G BUILT FTG	0	⊖ MOTEL UNITS	0	BY:	-/-
⊖ POWER TRANSFORMER	0/0	⊖ POWER PED	0	⊖ SIDEWALK ANCHOR	0	⊖ AERIAL NEW BUILT FTG	0	⊖ TOTAL COMMERCIAL	0	DESIGN	DATE:
⊖ JOINT TRANSFORMER	0/0	⊖ JOINT TRANS PED	0	⊖ SIDEWALK SET ANCHOR	0	⊖ U/G NEW BUILT FTG	0	⊖ TOTAL CUSTOMERS	0	BY:	
⊖ METAL POLE	0/0	⊖ TRANS PED	0	➔ POLE TO POLE GUY	0	⊖ TOTAL FOOTAGE	0	⊖ DENSITY PER MILE	0	DES-DRAFT	DATE:
⊖ CONCRETE POLE	0/0	⊖ TELEPHONE PED	0	⊖ OVERHEAD GUY	0	⊖ TOTAL BUILT MILES	0	⊖ POLE TRANSFERS	0	1	
TOTAL POLES	0/0	TOTAL PEDS	0	⊖ RISER	0	⊖ TOTAL NEW BUILT MILES	0	⊖ DROP SWAP	0	2	
										3	

SYSTEM NAME: LITTLE ROCK SCHOOL DISTRICT
LOCATION: LITTLE ROCK, AR
DRAWING NAME: 67 at W 17th St
PROJECT NAME: LITTLE ROCK SCHOOL DISTRICT
PROJECT NUMBER: 13-4525

REVISIONS
 0 50'
 SCALE: N

PAGE 3 OF 4